

The antenna AD-22/D is a log-periodic dipole antenna covering the frequency range from 1300 to 2700 MHz. The antenna is mainly intended for use in EMC applications, radio monitoring, etc. The antenna is composed of a boom element and 15 dipoles. All dipole elements and boom are made of brass and galvanically coated with silver. The antenna is enclosed in a radome made of ABS plastic material. The antenna support on the end enables mounting on masts with outer diameter between 1" (26 mm) and 2" (60 mm). The antenna could be used as transportable or as stationary.

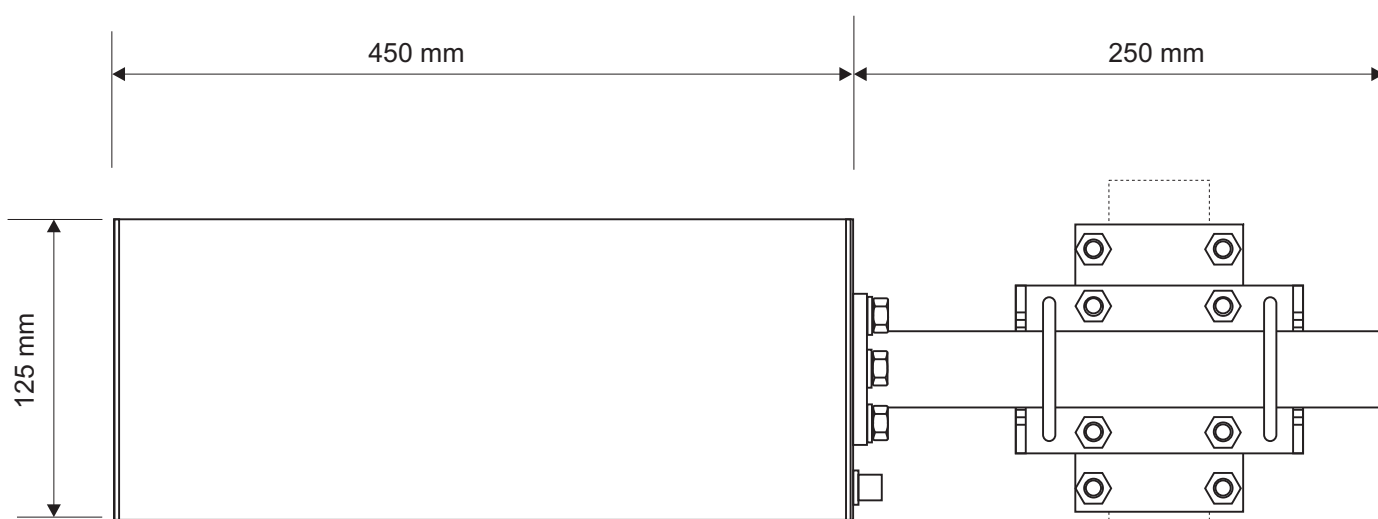

Frequency range	1300 - 2700 MHz
Impedance	50 ohm
VSWR	< 2 (DIAG. 1)
Gain	9 dBi (DIAG. 2)
Front-to-back ratio	> 18 dB
Polarization	HOR./VER.
Maximum power	50 W CW
Length	450 mm
Width	125 mm
Mass	1.8 kg
Wind velocity	150 km/h
Temperature range	-40...+70 °C



# AD-22/D

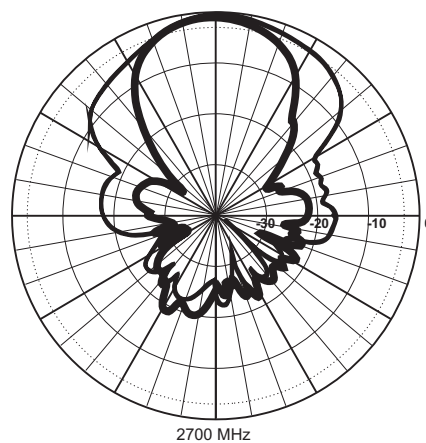
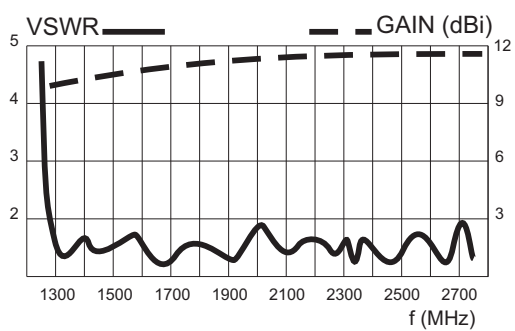

E plane ———  
H plane ———

